

KPM

KATHERINE PRICE MONDADORI



KATHERINE PRICE MONDADORI



Design consultant, Katherine Price Mondadori, is an interior designer who graduated with a degree in journalism. Equipped with a trained eye from her international experiences she credits travel as an inspiration for her unique vision. Her work with all elements of design, and development of artists, has been widely published. Her environmental commitment to New York's Premiere Central Park continues. In addition to art/design and nature, Katherines primary devotions are to her sons, Francesco and Filippo, from her marriage to Italian publishing magnate, Leonardo Mondadori. She lives in an eclectic apartment in Milan, a timeless park view apartment in New York City, and a cottage in West Palm Beach and plans to occupy a penthouse in KPM tower".

In Italy, thanks to her highly developed love for all that is beautiful, she has made her reputation as an interior designer, capable, like few others in the world of rediscovering and enhancing aspects of ancient art and traditions, reinterpreted in a modern key and yet essentially faithful to the aesthetic principles inherent in only the most refined neo-classical taste.

In this regard, Mrs. Mondadori is also known for uncanny ability to match her clients needs and tastes to her sense of neo-classical traditions.

KPM TOWER

The KPM TOWER will offer such modern amenities comparable only with the best of luxury; traditional hamman, sauna and state of the art gym will be available to the few discerning residents wishing to live at this luxury tower. 24 hour security service, ample underground parking space will be available for residents as well as a full time concierge desk which can accommodate any of your requests, available with the professional housekeeping services.



AMAZING DUBAI

Dubai is fast becoming the region's most important centre for commercial, residential, retail and tourism activities. From within It has quickly expanded to meet the demands of it's rapid growth and the incessant market requests for luxury properties. Part of Dubai's charm comes from the introduction of free zone areas and a tax free environment. The foreign freehold property ownership has given way to create a pampered lifestyle for Dubai in which there is nothing to envy with the best of what the world has to offer. The KPM TOWER is strategically located in the exclusive Dubai Marina reclamation area. Easy access to the scenic nearby beach front with it's exclusive beach clubs and golf courses, the KPM TOWER offers you the best of both worlds.

MARINA DUBAI

Dubai offers visitors a combination of things most cities don't have - safety; the old world charm of Arabia side by side with modernity; the best accommodation and lifestyle facilities in the world; excellent infrastructure services for conducting business and a high standard of living.

Among Dubai's top notch destination for hotel occupancy, Dubai Marina offers a lot more than being a conventional landmark. Upon completion of its project in the next five years, Dubai Marina will be one of the world's largest waterfront developments. Considered as one of Dubai's mega-projects, it features 250 berths for boats, luxurious hotels and elegant residential apartments.



V I B R A N T

C O L O R F U L

E X T R A O R D I N A R Y

G L A M O R O U S

A L L U R I N G

C O M P L E M E N T



MODERNLY DESIGNED

The KPM TOWER will include spectacular modernly designed studios and one bedrooms reflecting today's lifestyle. Exclusive and rare finishes, combined with top of the line appliances make these apartments one of a kind. The residents of KPM TOWER will enjoy views of the professionally landscaped gardens and courtyards, and the magic of the marina.

The thoughtfully designed two bedroom duplex penthouses will offer breathtaking and awe inspiring views of Dubai and its marina. The penthouses will offer the ultimate in living style.

ELEGANT

CHARM

INTERIORS & LUXURY

They are a statement, with their seamless stainless steel kitchens, wonderfully appointed interiors, and bathrooms by Bisazza and Dornbracht fixtures, this is the ultimate Dubai address for exclusivity...

The tower features studios and one bedroom apartments, comfortably designed to accommodate couples and small families. Two bedroom units are available with overlooking views of the marina and the landscaped gardens and courtyard. The penthouse features a luxury 2 bedroom, 2 full baths and a modern full appliances cat in kitchen with breathtaking views.

STYLE

COMFORT



PRIME LOCATION

The KPM TOWER is strategically located in the exclusive Dubai Marina reclamation area. Easy access to the scenic nearby beach front with it's exclusive beach clubs and golf courses, the KPM TOWER offers you the best of both worlds. Shopping centers and luxury hotels are conveniently located in the neighbourhood, giving you both the tranquillity of the sea and the bustling of what makes Dubai Marina.

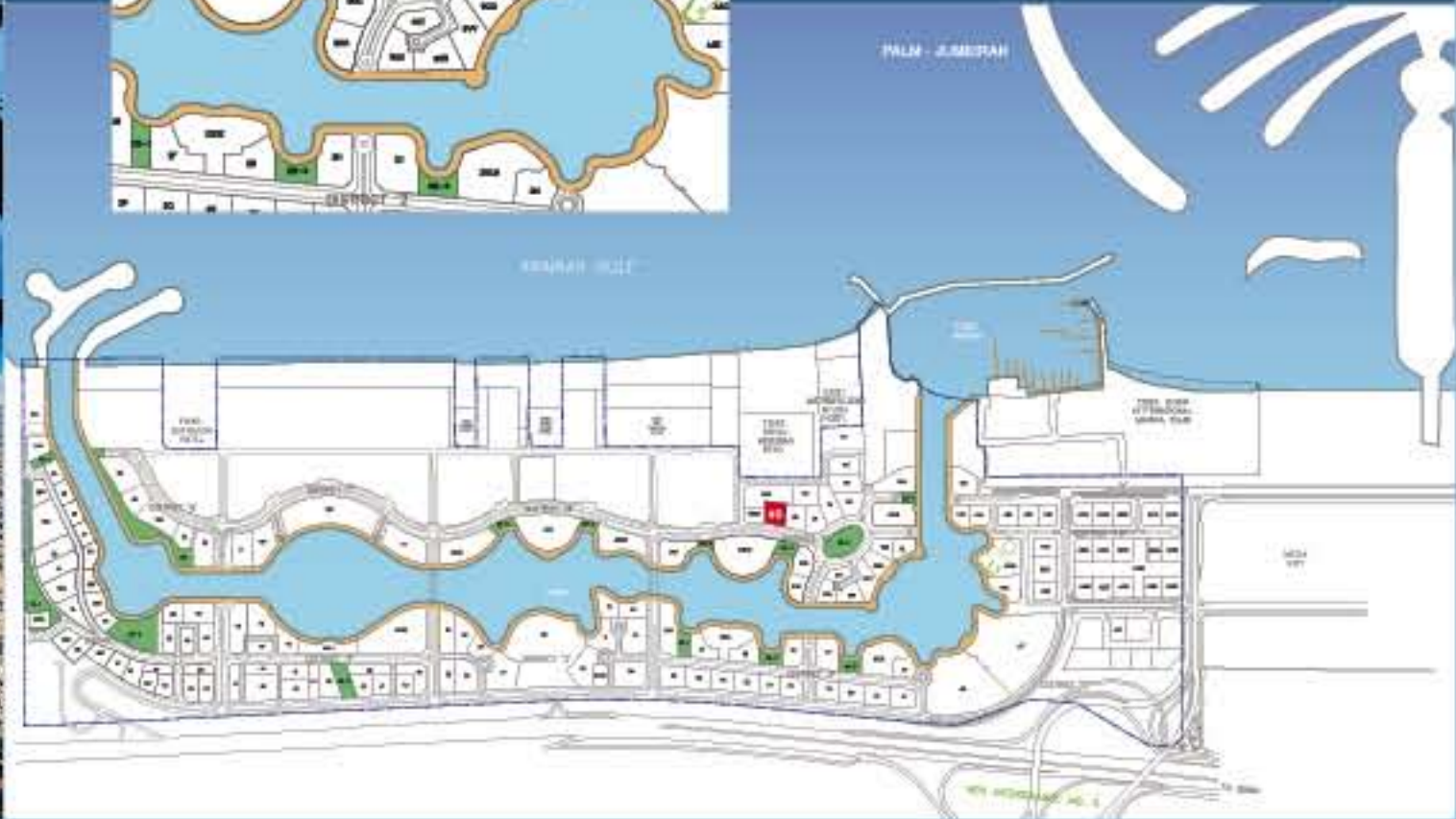

FLOOR PLANS

U N I Q U E

E X Q U I S I T E

D I S T I N C T I V E



GROUND FLOOR RETAIL



- RETAIL 01**
886.22 sq.ft.
- RETAIL 02**
855.65 sq.ft.
- RETAIL 03**
651.13 sq.ft.
- RETAIL 04**
1019.90 sq.ft.
- RETAIL 05**
1000.23 sq.ft.
- RETAIL 06**
552.75 sq.ft.
- RETAIL 07**
591.60 sq.ft.

1ST FLOOR RETAIL

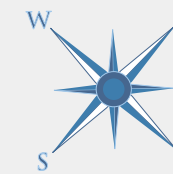

- RETAIL 01**
811.30 sq.ft.
- RETAIL 02**
1583.65 sq.ft.
- RETAIL 03**
1417.55 sq.ft.
- RETAIL 04**
1007.30 sq.ft.
- RETAIL 05**
860.70 sq.ft.
- RETAIL 06**
1059.00 sq.ft.
- RETAIL 07**
658.30 sq.ft.
- RETAIL 08**
725.73 sq.ft.
- RETAIL 09**
635.30 sq.ft.
- RETAIL 10**
796.45 sq.ft.



2ND FLOOR
TYPICAL FLOOR



FLAT NO. B4 & B6
713.55 sq.ft.



FLAT NO. B5
775.65 sq.ft.

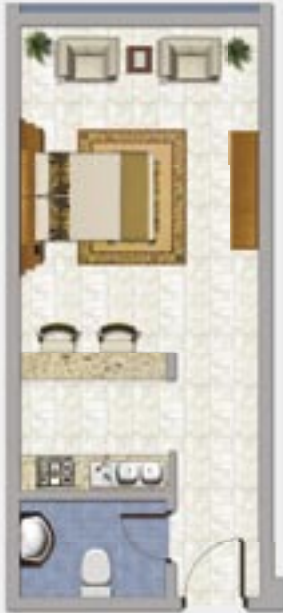

FLAT NO. S9
388.00 sq.ft.



FLAT NO. S3
564.50 sq.ft.

2ND FLOOR
TYPICAL FLOOR

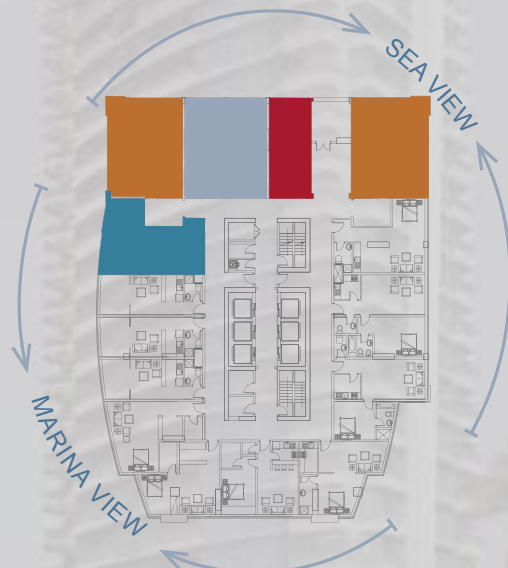

2ND FLOOR TYPICAL FLOOR



FLAT NO. S4 & S5
409.00 sq.ft.



FLAT NO. S8
514.00 sq.ft.



FLAT NO. S1
532.27 sq.ft.



FLAT NO. B3
704.30 sq.ft.



FLAT NO. S6
396.00 sq.ft.



FLAT NO. B1
560.90 sq.ft.



FLAT NO. B2
640.80 sq.ft.



FLAT NO. S2
519.70 sq.ft.



FLAT NO. S7
505.90 sq.ft.

2ND FLOOR TYPICAL FLOOR

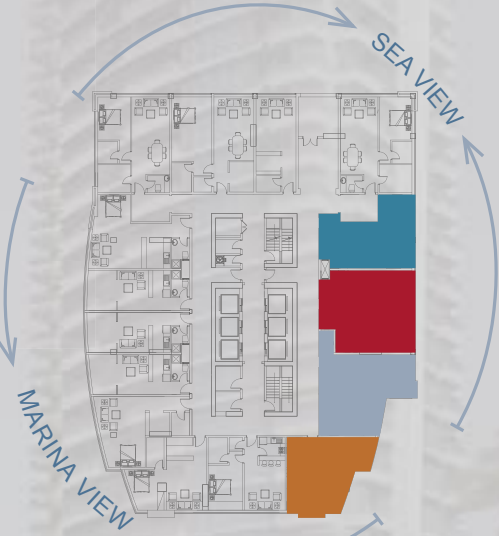



3rd & 4th FLOOR
TYPICAL FLOOR



FLAT NO. B4 & B7
732.80 sq.ft.



FLAT NO. B5 & B6
775.67 sq.ft.



FLAT NO. S3
545.20 sq.ft.



FLAT NO. S4 & S5
409.00 sq.ft.

3rd & 4th FLOOR
TYPICAL FLOOR

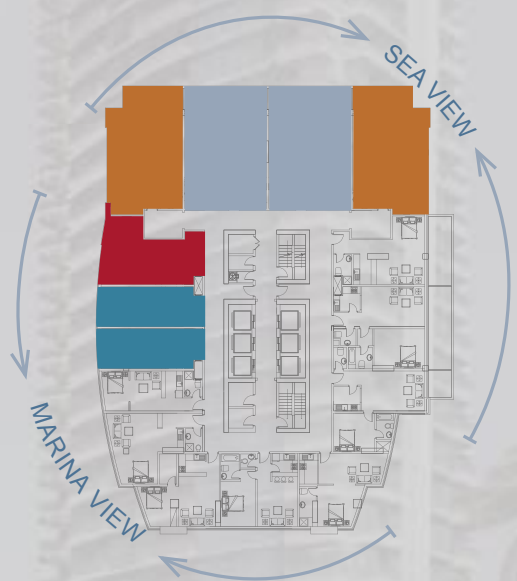

3rd & 4th FLOOR
TYPICAL FLOOR

3rd & 4th FLOOR
TYPICAL FLOOR



FLAT NO. S6
396.00 sq.ft.



FLAT NO. S8
514.00 sq.ft.



FLAT NO. S1
532.27 sq.ft.



FLAT NO. B3
501.40 sq.ft.



FLAT NO. S7
505.90 sq.ft.



FLAT NO. B1
560.90 sq.ft.



FLAT NO. B2
640.80 sq.ft.



FLAT NO. S2
704.30 sq.ft.

5th TO 32nd FLOOR
TYPICAL FLOOR

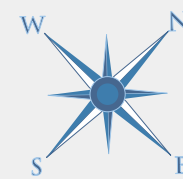

5th TO 32nd FLOOR
TYPICAL FLOOR



FLAT NO. S3 & S4
477.00 sq.ft.



FLAT NO. B1 & A1
844.46 sq.ft.



FLAT NO. S5 & S2
430.60sq.ft.

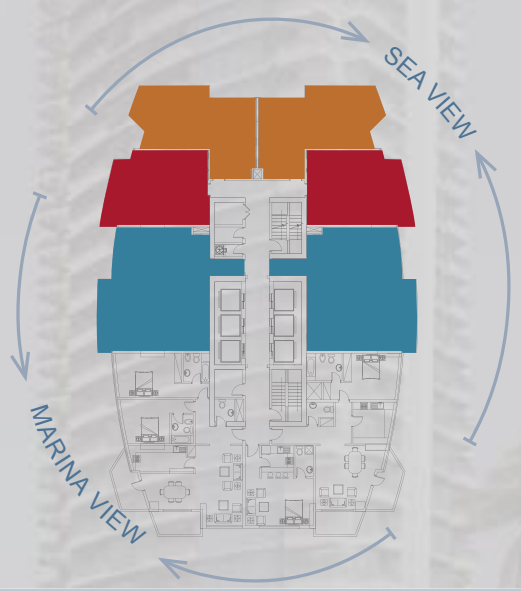

5th TO 32nd FLOOR
TYPICAL FLOOR



FLAT NO. 2A
1306.48 sq.ft.



FLAT NO. S1
430.60 sq.ft.



FLAT NO. C1
959.53 sq.ft.

33RD TO 35TH FLOOR
TYPICAL FLOOR





33RD TO 35TH FLOOR
TYPICAL FLOOR

33RD TO 35TH FLOOR
TYPICAL FLOOR



FLAT NO. S3 & S4
477.00 sq.ft.



FLAT NO. B1 & A1
816.90 sq.ft.



FLAT NO. S5 & S2
430.60 sq.ft.



FLAT NO. A2
1248.55 sq.ft.



FLAT NO. S1
430.60 sq.ft.



FLAT NO. C1
903.45 sq.ft.

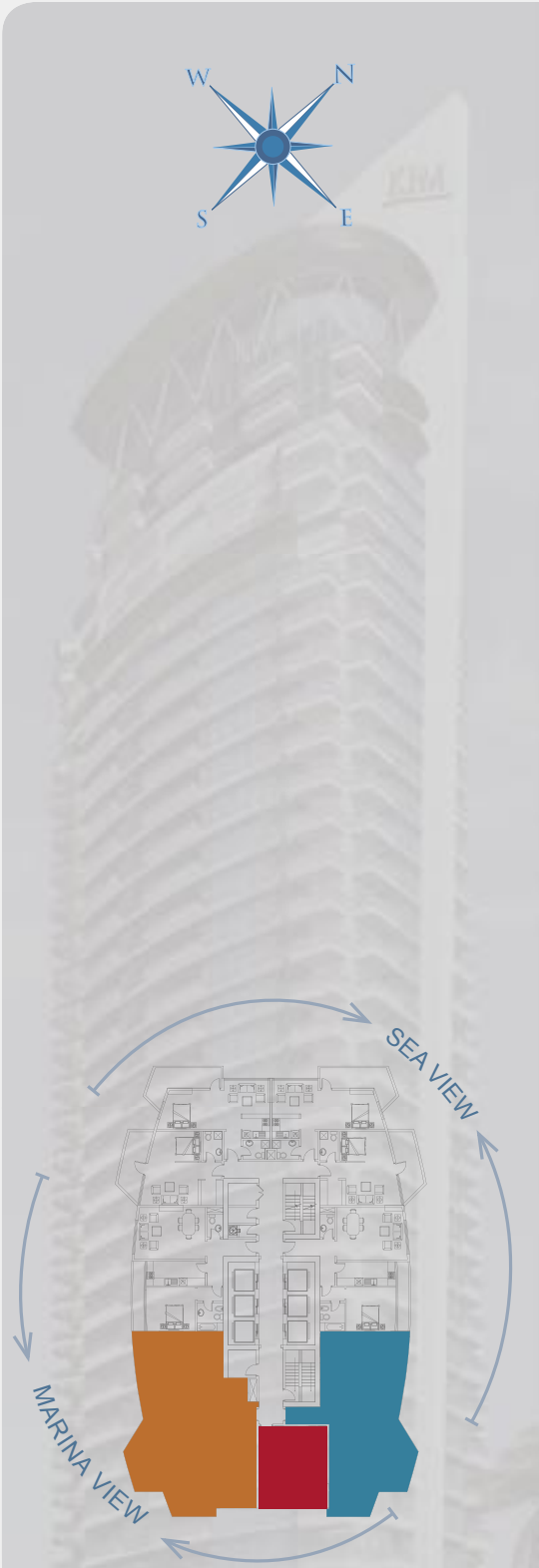

36TH FLOOR
ALTERNATIVE 1



36TH FLOOR
ALTERNATIVE 1

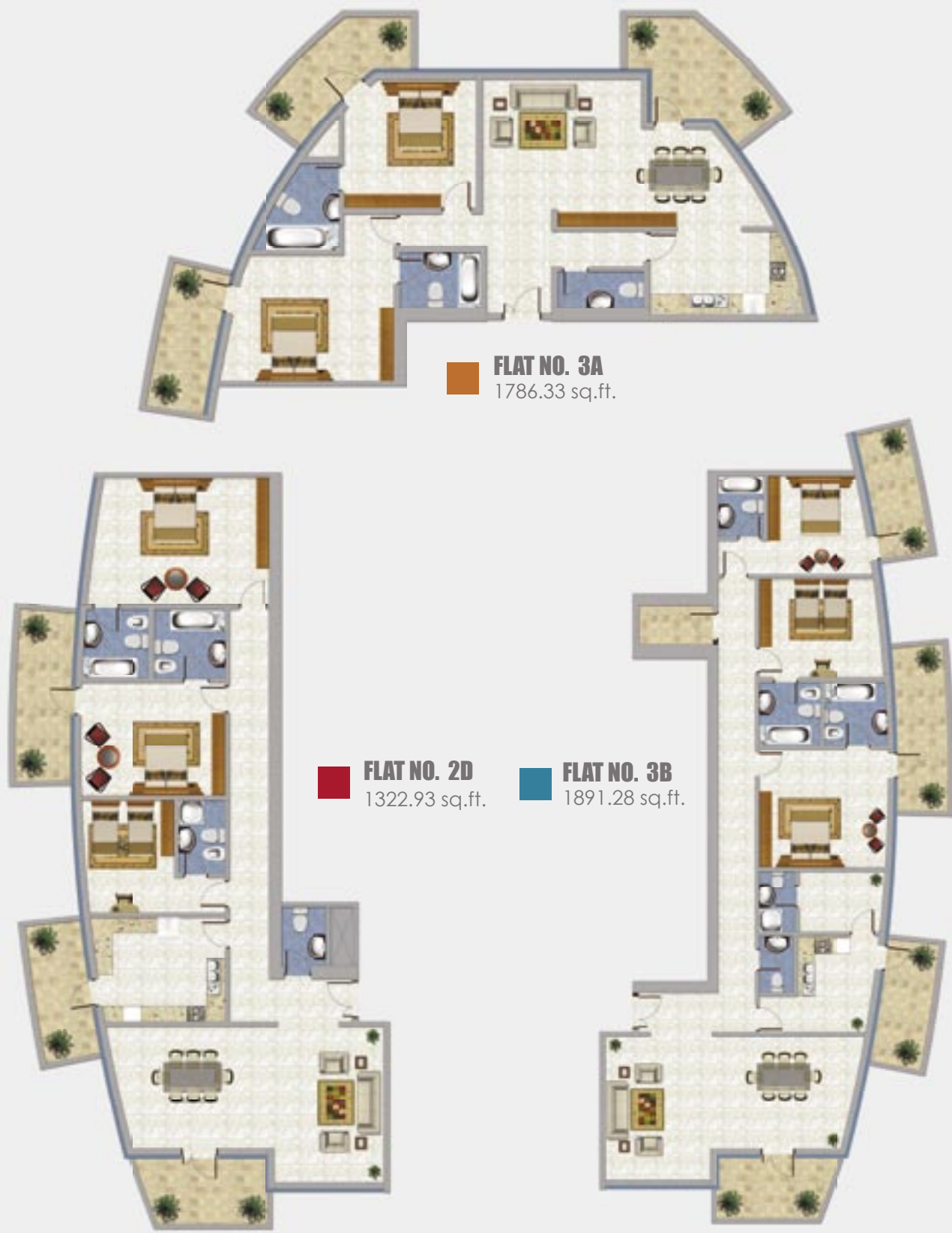

FLAT NO. 3A
1786.33 sq.ft.

FLAT NO. 2D
1322.93 sq.ft.

FLAT NO. 3B
1891.28 sq.ft.

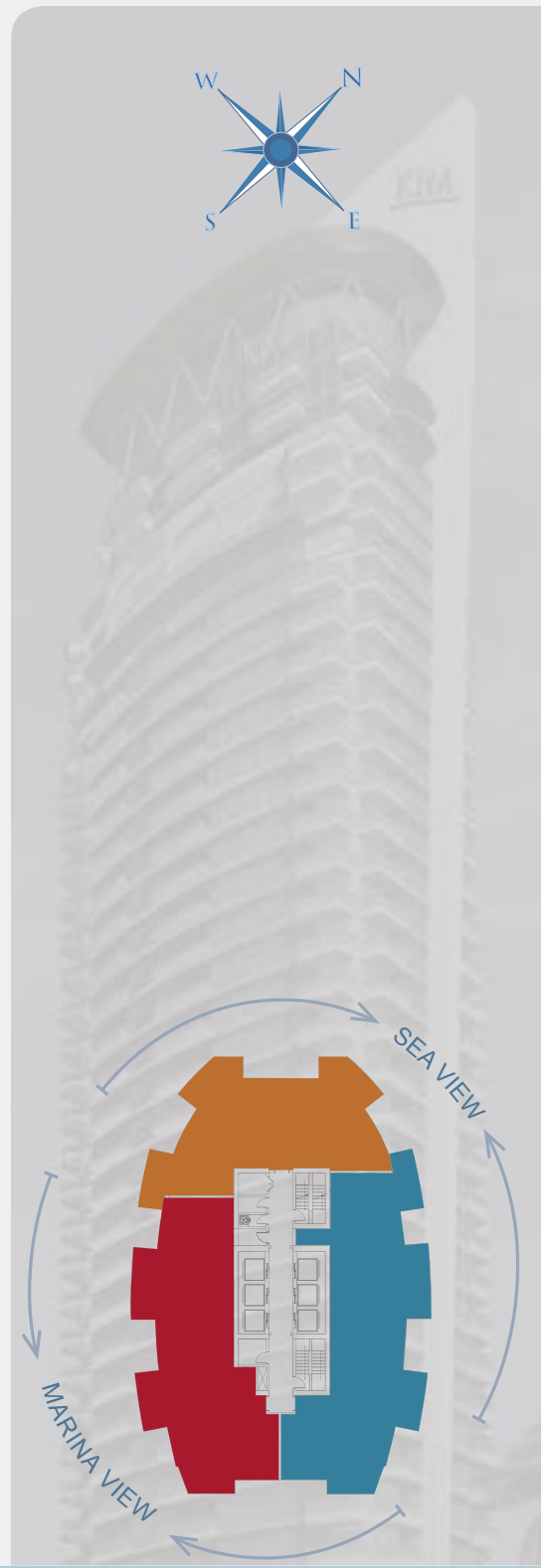

36TH FLOOR ALTERNATIVE 2



36TH FLOOR ALTERNATIVE 2



FLAT NO. 2A
1153.40 sq.ft.



FLAT NO. 2B
1131.65 sq.ft.



FLAT NO. 2D
1336.50 sq.ft.



FLAT NO. 2C
1282.88 sq.ft.

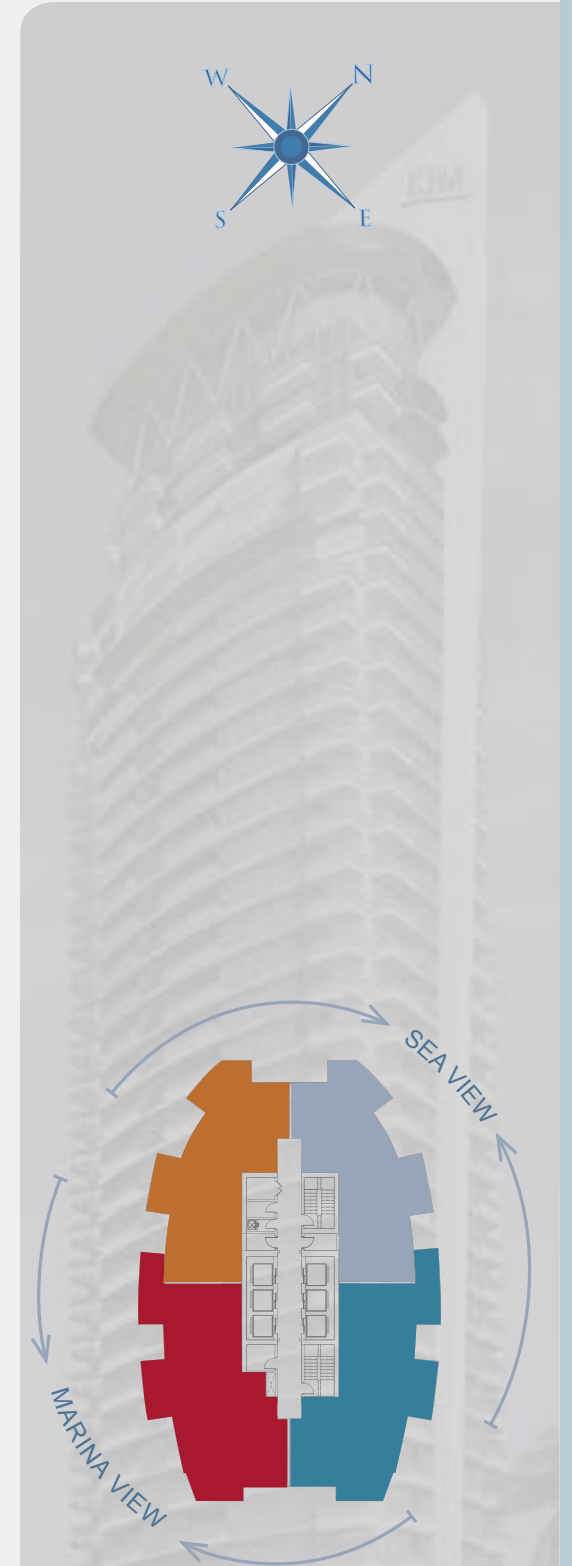



PENTHOUSE LEVEL 1
36TH FLOOR
ALTERNATIVE 3

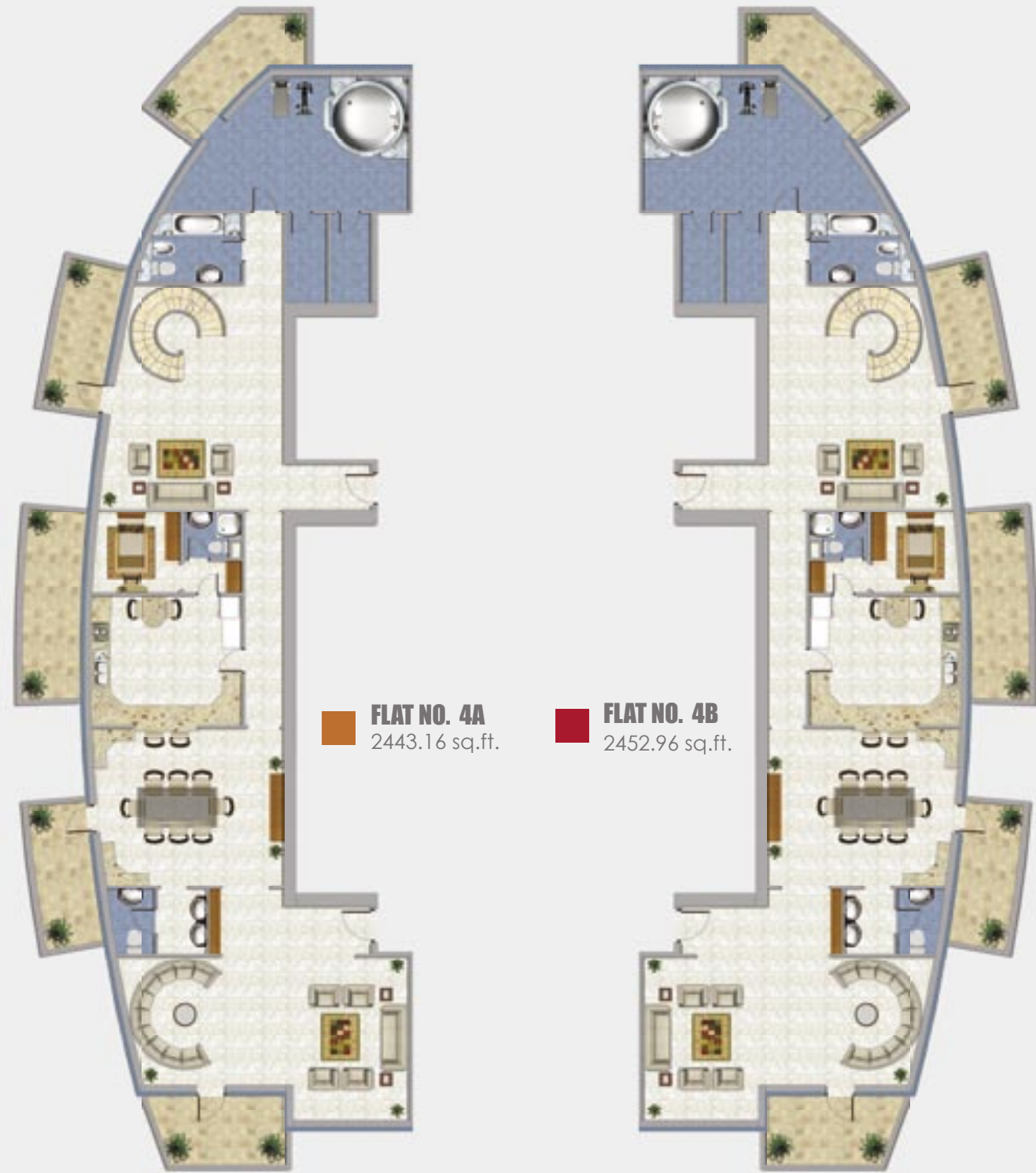

PENTHOUSE LEVEL 1
36TH FLOOR
ALTERNATIVE 3

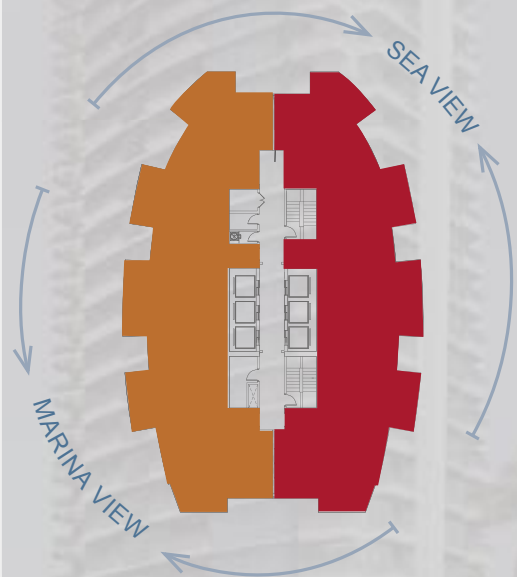



PENTHOUSE LEVEL 2
36TH FLOOR
ALTERNATIVE 3



PENTHOUSE LEVEL 2
36TH FLOOR
ALTERNATIVE 3

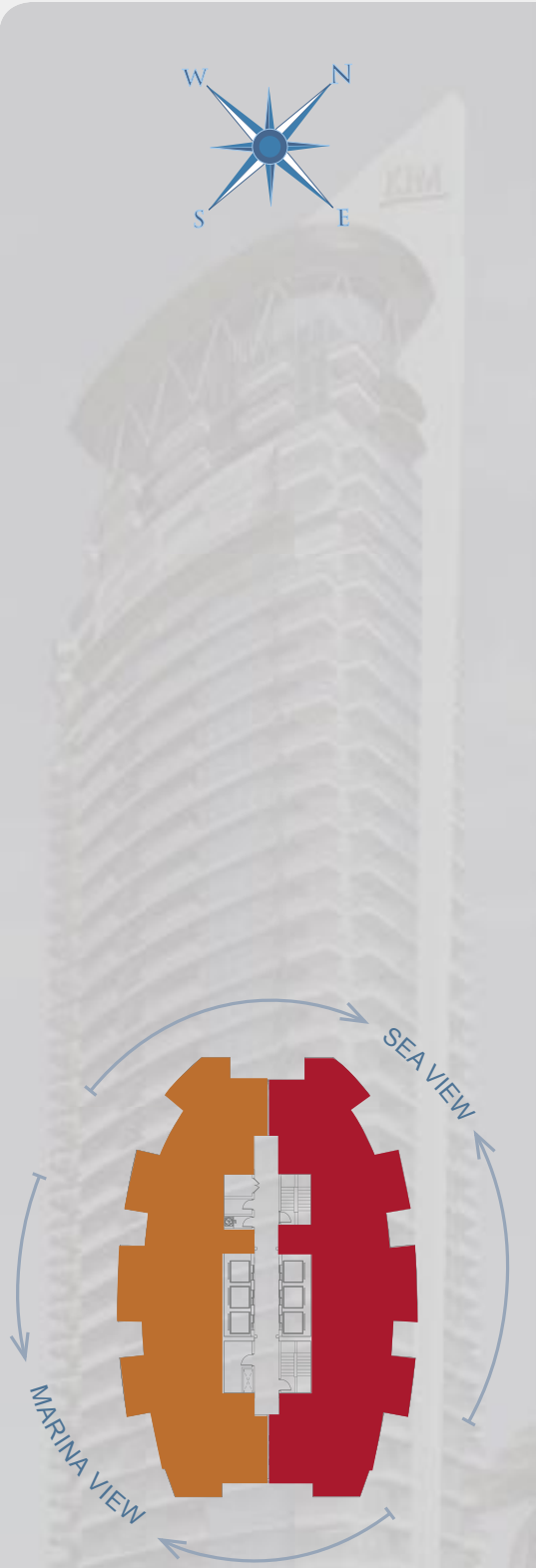
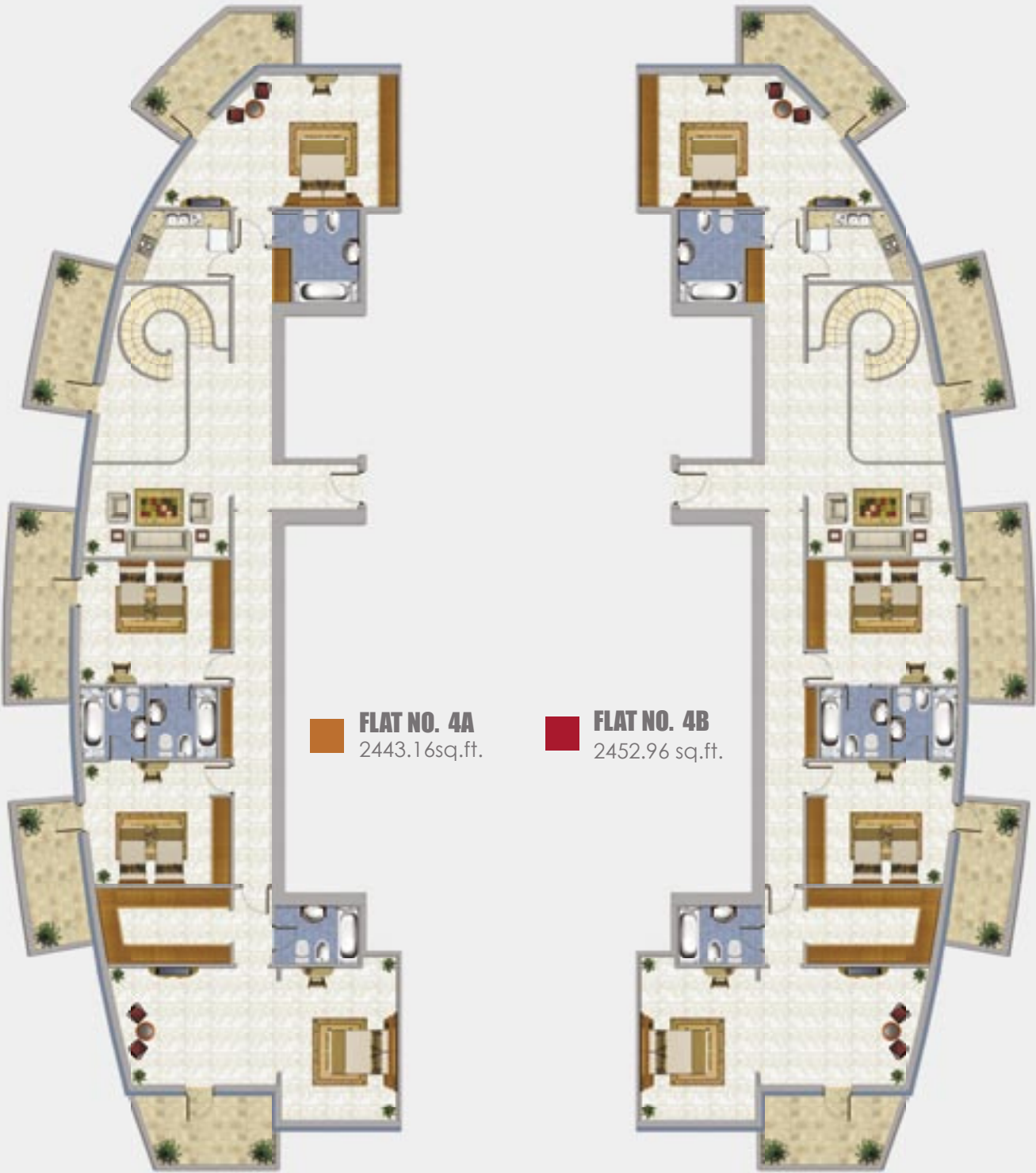



37 TH FLOOR TYPICAL FLOOR



37 TH FLOOR TYPICAL FLOOR

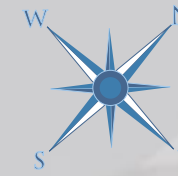

FLAT NO. 4A
2467.80 sq.ft.



FLAT NO. 4B
2440.35 sq.ft.

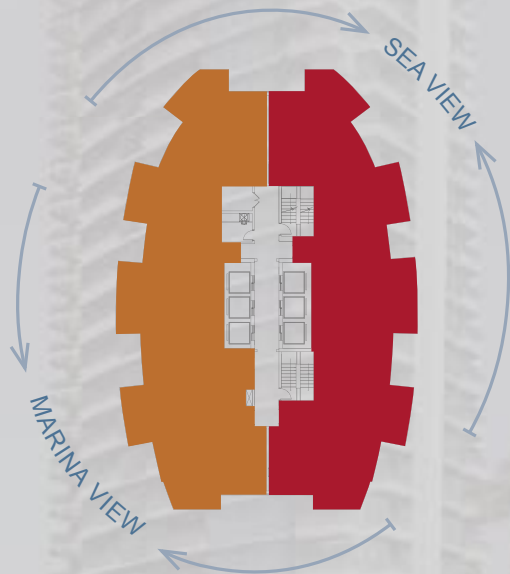



HEALTH CLUB
ROOF TOP



OWNER & DEVELOPER



NEW WORLD INVESTMENTS GROUP
NEW APPROACH. NEW POSSIBILITIES.

PROJECT CONSULTANT & MANAGEMENT



www.leonardodubai.com

INVESTOR & INVESTMENTS MANAGER



ENGINEERING CONSULTANT



INTERIOR DESIGNER



AUTHORIZED SALES AND MARKETING



Al Masah:
Tel: +971 4 4224200/02
Fax: +971 4 4224203
info@almasahint.com
www.almasahint.com
Almas: Tel: +971 4 42246603
Fax: +971 42246605
almas_dubai2004@yahoo.com
www.almasahint.com

